

Study Report



Analyzed File	Board_V3.3 v23
Version	Autodesk Fusion 360 (2.0.2865)
Creation Date	2017-03-19, 23:41:38
Author	GChino

☐ Project Properties

Title	Studies
Author	GChino

Board_V3.3 v23:1

Study 1 - Static Stress

Study Properties

Study Type	Static Stress
Last Modification Date	2017-03-19, 23:09:30

Settings

General

Contact Tolerance	0.1 mm
Remove Rigid Body Modes	No

Mesh

Average Element Size (% of model size)	
Solids	10
Scale Mesh Size Per Part	No
Average Element Size (absolute value)	-
Element Order	Parabolic
Create Curved Mesh Elements	No
Max. Turn Angle on Curves (Deg.)	60
Max. Adjacent Mesh Size Ratio	1.5
Max. Aspect Ratio	10
Minimum Element Size (% of average size)	20

Adaptive Mesh Refinement

Number of Refinement Steps	0
Results Convergence Tolerance (%)	20
Portion of Elements to Refine (%)	10
Results for Baseline Accuracy	Von Mises Stress

Materials

Component	Material	Safety Factor
Main_leftover (1)	PC/ABS Plastic	Yield Strength
Main_leftover	PC/ABS Plastic	Yield Strength
drive_cavity_cutter	PC/ABS Plastic	Yield Strength
Original_Stud1 (1)	PC/ABS Plastic	Yield Strength
Original_Stud2 (1)	PC/ABS Plastic	Yield Strength
Original_Stud3 (1)	PC/ABS Plastic	Yield Strength
Original_Stud4 (1)	PC/ABS Plastic	Yield Strength
Original_Stud1 (1) (1)	PC/ABS Plastic	Yield Strength
Original_Stud1 (1) (2)	PC/ABS Plastic	Yield Strength
Original_Stud1 (1) (3)	PC/ABS Plastic	Yield Strength
Original_Stud1 (1) (4)	PC/ABS Plastic	Yield Strength
Original_Stud1 (1) (5)	PC/ABS Plastic	Yield Strength
Original_Stud1 (1) (6)	PC/ABS Plastic	Yield Strength
Original_Stud1 (1) (7)	PC/ABS Plastic	Yield Strength
Original_Stud2 (1) (1)	PC/ABS Plastic	Yield Strength
Original_Stud2 (1) (2)	PC/ABS Plastic	Yield Strength
Original_Stud2 (1) (3)	PC/ABS Plastic	Yield Strength
Original_Stud2 (1) (4)	PC/ABS Plastic	Yield Strength
Original_Stud2 (1) (5)	PC/ABS Plastic	Yield Strength
Original_Stud2 (1) (6)	PC/ABS Plastic	Yield Strength

Original_Stud2 (1) (7)	PC/ABS Plastic	Yield Strength
Original_Stud3 (1) (1)	PC/ABS Plastic	Yield Strength
Original_Stud3 (1) (2)	PC/ABS Plastic	Yield Strength
Original_Stud3 (1) (3)	PC/ABS Plastic	Yield Strength
Original_Stud3 (1) (4)	PC/ABS Plastic	Yield Strength
Original_Stud3 (1) (5)	PC/ABS Plastic	Yield Strength
Original_Stud4 (1) (1)	PC/ABS Plastic	Yield Strength
Original_Stud4 (1) (2)	PC/ABS Plastic	Yield Strength
Original_Stud4 (1) (3)	PC/ABS Plastic	Yield Strength
Original_Stud4 (1) (4)	PC/ABS Plastic	Yield Strength
Original_Stud4 (1) (5)	PC/ABS Plastic	Yield Strength
Original_Stud3 (1) (1) (1)	PC/ABS Plastic	Yield Strength
Original_Stud4 (1) (1) (1)	PC/ABS Plastic	Yield Strength
Original_Stud1 (1) (7) (1)	PC/ABS Plastic	Yield Strength
Original_Stud1 (1) (3) (1)	PC/ABS Plastic	Yield Strength
Original_Stud2 (1) (7) (1)	PC/ABS Plastic	Yield Strength
Original_Stud1 (1) (1) (1)	PC/ABS Plastic	Yield Strength
Original_Stud1 (1) (2) (1)	PC/ABS Plastic	Yield Strength
Original_Stud1 (1) (5) (1)	PC/ABS Plastic	Yield Strength
Original_Stud1 (1) (4) (1)	PC/ABS Plastic	Yield Strength
Original_Stud2 (1) (4) (1)	PC/ABS Plastic	Yield Strength
Original_Stud2 (1) (5) (1)	PC/ABS Plastic	Yield Strength
Original_Stud2 (1) (6) (1)	PC/ABS Plastic	Yield Strength
Original_Stud4 (1) (3) (1)	PC/ABS Plastic	Yield Strength
Original_Stud4 (1) (2) (1)	PC/ABS Plastic	Yield Strength
Original_Stud4 (1) (4) (1)	PC/ABS Plastic	Yield Strength
Original_Stud4 (1) (5) (1)	PC/ABS Plastic	Yield Strength
Original_Stud2 (1) (2) (1)	PC/ABS Plastic	Yield Strength
Original_Stud2 (1) (3) (1)	PC/ABS Plastic	Yield Strength
Original_Stud2 (1) (1) (1)	PC/ABS Plastic	Yield Strength
Original_Stud3 (1) (4) (1)	PC/ABS Plastic	Yield Strength
Original_Stud3 (1) (5) (1)	PC/ABS Plastic	Yield Strength
Original_Stud1 (1) (6) (1)	PC/ABS Plastic	Yield Strength
Original_Stud3 (1) (2) (1)	PC/ABS Plastic	Yield Strength
Original_Stud3 (1) (3) (1)	PC/ABS Plastic	Yield Strength
Body554	PC/ABS Plastic	Yield Strength
Body557	PC/ABS Plastic	Yield Strength
Body560	PC/ABS Plastic	Yield Strength
Body565	PC/ABS Plastic	Yield Strength
Body578	PC/ABS Plastic	Yield Strength
Body579	PC/ABS Plastic	Yield Strength
Body580	PC/ABS Plastic	Yield Strength
Body581	PC/ABS Plastic	Yield Strength
Body586	PC/ABS Plastic	Yield Strength
Body587	PC/ABS Plastic	Yield Strength
Body588	PC/ABS Plastic	Yield Strength
Body589	PC/ABS Plastic	Yield Strength
Body594	PC/ABS Plastic	Yield Strength
Body595	PC/ABS Plastic	Yield Strength
Body596	PC/ABS Plastic	Yield Strength
Body597	PC/ABS Plastic	Yield Strength
Main_top:1/Back_L_Light	PC/ABS Plastic	Yield Strength
Main_top:1/Front_L_Light	PC/ABS Plastic	Yield Strength
Main_top:1/Front_R_Light	PC/ABS Plastic	Yield Strength
Main_top:1/Back_R_Light	PC/ABS Plastic	Yield Strength
Main_top:1/Body27	PC/ABS Plastic	Yield Strength
Main_btm:1	PC/ABS Plastic	Yield Strength

☐ PC/ABS Plastic

Density	3.573E-07 kg / mm ³
Young's Modulus	2780 MPa
Poisson's Ratio	0.4
Yield Strength	54.4 MPa
Ultimate Tensile Strength	54.1 MPa
Thermal Conductivity	2.4E-04 W / (mm C)
Thermal Expansion Coefficient	6.7E-05 / C
Specific Heat	2133 J / (kg C)

☐ Contacts

☐ Bonded

Name
[S] Bonded1 [Main_top:1(Body27) Main_btm:1]
[S] Bonded2 [Main_top:1(Body27) Main_btm:1]
[S] Bonded3 [Main_top:1(Body27) Main_btm:1]
[S] Bonded4 [Main_top:1(Body27) Main_btm:1]
[S] Bonded5 [Main_top:1(Back_R_Light) Main_top:1(Body27)]
[S] Bonded6 [Main_top:1(Back_R_Light) Main_top:1(Body27)]
[S] Bonded7 [Main_top:1(Back_R_Light) Main_top:1(Body27)]
[S] Bonded8 [Main_top:1(Front_R_Light) Main_top:1(Body27)]
[S] Bonded9 [Main_top:1(Front_R_Light) Main_top:1(Body27)]
[S] Bonded10 [Main_top:1(Front_R_Light) Main_top:1(Body27)]
[S] Bonded11 [Main_top:1(Front_L_Light) Main_top:1(Body27)]
[S] Bonded12 [Main_top:1(Front_L_Light) Main_top:1(Body27)]
[S] Bonded13 [Main_top:1(Front_L_Light) Main_top:1(Body27)]
[S] Bonded14 [Main_top:1(Back_L_Light) Main_top:1(Body27)]
[S] Bonded15 [Main_top:1(Back_L_Light) Main_top:1(Body27)]
[S] Bonded16 [Main_top:1(Back_L_Light) Main_top:1(Body27)]
[S] Bonded17 [Board_V3.3 v23:1(Body597) Main_top:1(Body27)]
[S] Bonded18 [Board_V3.3 v23:1(Body596) Main_top:1(Body27)]
[S] Bonded19 [Board_V3.3 v23:1(Body595) Main_top:1(Body27)]
[S] Bonded20 [Board_V3.3 v23:1(Body594) Main_top:1(Body27)]
[S] Bonded21 [Board_V3.3 v23:1(Body589) Main_btm:1]
[S] Bonded22 [Board_V3.3 v23:1(Body588) Main_top:1(Body27)]
[S] Bonded23 [Board_V3.3 v23:1(Body588) Main_top:1(Body27)]
[S] Bonded24 [Board_V3.3 v23:1(Body587) Main_btm:1]
[S] Bonded25 [Board_V3.3 v23:1(Body586) Main_top:1(Body27)]
[S] Bonded26 [Board_V3.3 v23:1(Body586) Main_top:1(Body27)]
[S] Bonded27 [Board_V3.3 v23:1(Body581) Main_btm:1]
[S] Bonded28 [Board_V3.3 v23:1(Body580) Main_btm:1]
[S] Bonded29 [Board_V3.3 v23:1(Body579) Main_top:1(Body27)]
[S] Bonded30 [Board_V3.3 v23:1(Body579) Main_top:1(Body27)]
[S] Bonded31 [Board_V3.3 v23:1(Body578) Main_top:1(Body27)]
[S] Bonded32 [Board_V3.3 v23:1(Body578) Main_top:1(Body27)]
[S] Bonded33 [Board_V3.3 v23:1(Original_Stud3 (1) (3) (1)) Main_top:1(Body27)]
[S] Bonded34 [Board_V3.3 v23:1(Original_Stud3 (1) (3) (1)) Main_top:1(Body27)]
[S] Bonded35 [Board_V3.3 v23:1(Original_Stud3 (1) (3) (1)) Main_top:1(Body27)]
[S] Bonded36 [Board_V3.3 v23:1(Original_Stud3 (1) (3) (1)) Main_top:1(Body27)]
[S] Bonded37 [Board_V3.3 v23:1(Original_Stud3 (1) (2) (1)) Main_top:1(Body27)]
[S] Bonded38 [Board_V3.3 v23:1(Original_Stud3 (1) (2) (1)) Main_top:1(Body27)]
[S] Bonded39 [Board_V3.3 v23:1(Original_Stud3 (1) (2) (1)) Main_top:1(Body27)]
[S] Bonded40 [Board_V3.3 v23:1(Original_Stud3 (1) (2) (1)) Main_top:1(Body27)]
[S] Bonded41 [Board_V3.3 v23:1(Original_Stud3 (1) (2) (1)) Main_top:1(Body27)]
[S] Bonded42 [Board_V3.3 v23:1(Original_Stud1 (1) (6) (1)) Main_top:1(Body27)]
[S] Bonded43 [Board_V3.3 v23:1(Original_Stud1 (1) (6) (1)) Main_top:1(Body27)]

[S] Bonded276 [Board_V3.3 v23:1(drive_cavity_cutter) Main_top:1(Body27)]
[S] Bonded277 [Board_V3.3 v23:1(drive_cavity_cutter) Board_V3.3 v23:1(Body589)]
[S] Bonded278 [Board_V3.3 v23:1(drive_cavity_cutter) Board_V3.3 v23:1(Body588)]
[S] Bonded279 [Board_V3.3 v23:1(drive_cavity_cutter) Board_V3.3 v23:1(Body587)]
[S] Bonded280 [Board_V3.3 v23:1(drive_cavity_cutter) Board_V3.3 v23:1(Body586)]
[S] Bonded281 [Board_V3.3 v23:1(drive_cavity_cutter) Board_V3.3 v23:1(Body581)]
[S] Bonded282 [Board_V3.3 v23:1(drive_cavity_cutter) Board_V3.3 v23:1(Body580)]
[S] Bonded283 [Board_V3.3 v23:1(drive_cavity_cutter) Board_V3.3 v23:1(Body579)]
[S] Bonded284 [Board_V3.3 v23:1(drive_cavity_cutter) Board_V3.3 v23:1(Body578)]
[S] Bonded285 [Board_V3.3 v23:1(Main_leftover) Main_btm:1]
[S] Bonded286 [Board_V3.3 v23:1(Main_leftover) Main_btm:1]
[S] Bonded287 [Board_V3.3 v23:1(Main_leftover) Main_btm:1]
[S] Bonded288 [Board_V3.3 v23:1(Main_leftover) Main_btm:1]
[S] Bonded289 [Board_V3.3 v23:1(Main_leftover) Main_top:1(Body27)]
[S] Bonded290 [Board_V3.3 v23:1(Main_leftover) Main_top:1(Body27)]
[S] Bonded291 [Board_V3.3 v23:1(Main_leftover) Main_top:1(Body27)]
[S] Bonded292 [Board_V3.3 v23:1(Main_leftover) Main_top:1(Body27)]
[S] Bonded293 [Board_V3.3 v23:1(Main_leftover) Main_top:1(Body27)]
[S] Bonded294 [Board_V3.3 v23:1(Main_leftover) Main_top:1(Body27)]
[S] Bonded295 [Board_V3.3 v23:1(Main_leftover) Main_top:1(Body27)]
[S] Bonded296 [Board_V3.3 v23:1(Main_leftover) Main_top:1(Body27)]
[S] Bonded297 [Board_V3.3 v23:1(Main_leftover) Main_btm:1]
[S] Bonded298 [Board_V3.3 v23:1(Main_leftover) Main_btm:1]
[S] Bonded299 [Board_V3.3 v23:1(Main_leftover) Main_top:1(Body27)]
[S] Bonded300 [Board_V3.3 v23:1(Main_leftover) Main_btm:1]
[S] Bonded301 [Board_V3.3 v23:1(Main_leftover) Main_btm:1]
[S] Bonded302 [Board_V3.3 v23:1(Main_leftover) Main_top:1(Body27)]
[S] Bonded303 [Board_V3.3 v23:1(Main_leftover) Main_btm:1]
[S] Bonded304 [Board_V3.3 v23:1(Main_leftover) Main_btm:1]
[S] Bonded305 [Board_V3.3 v23:1(Main_leftover) Main_btm:1]
[S] Bonded306 [Board_V3.3 v23:1(Main_leftover) Main_btm:1]
[S] Bonded307 [Board_V3.3 v23:1(Main_leftover) Main_btm:1]
[S] Bonded308 [Board_V3.3 v23:1(Main_leftover) Main_top:1(Body27)]
[S] Bonded309 [Board_V3.3 v23:1(Main_leftover) Main_top:1(Body27)]
[S] Bonded310 [Board_V3.3 v23:1(Main_leftover) Main_top:1(Body27)]
[S] Bonded311 [Board_V3.3 v23:1(Main_leftover) Main_top:1(Body27)]
[S] Bonded312 [Board_V3.3 v23:1(Main_leftover) Main_top:1(Body27)]
[S] Bonded313 [Board_V3.3 v23:1(Main_leftover) Main_top:1(Back_L_Light)]
[S] Bonded314 [Board_V3.3 v23:1(Main_leftover) Main_btm:1]
[S] Bonded315 [Board_V3.3 v23:1(Main_leftover) Main_btm:1]
[S] Bonded316 [Board_V3.3 v23:1(Main_leftover) Main_btm:1]
[S] Bonded317 [Board_V3.3 v23:1(Main_leftover) Main_btm:1]
[S] Bonded318 [Board_V3.3 v23:1(Main_leftover) Main_top:1(Body27)]
[S] Bonded319 [Board_V3.3 v23:1(Main_leftover) Main_top:1(Body27)]
[S] Bonded320 [Board_V3.3 v23:1(Main_leftover) Main_top:1(Body27)]
[S] Bonded321 [Board_V3.3 v23:1(Main_leftover) Main_btm:1]
[S] Bonded322 [Board_V3.3 v23:1(Main_leftover) Main_btm:1]
[S] Bonded323 [Board_V3.3 v23:1(Main_leftover) Main_btm:1]
[S] Bonded324 [Board_V3.3 v23:1(Main_leftover) Main_btm:1]
[S] Bonded325 [Board_V3.3 v23:1(Main_leftover) Main_btm:1]
[S] Bonded326 [Board_V3.3 v23:1(Main_leftover) Main_top:1(Body27)]
[S] Bonded327 [Board_V3.3 v23:1(Main_leftover) Main_top:1(Body27)]
[S] Bonded328 [Board_V3.3 v23:1(Main_leftover) Main_top:1(Body27)]
[S] Bonded329 [Board_V3.3 v23:1(Main_leftover) Main_top:1(Body27)]
[S] Bonded330 [Board_V3.3 v23:1(Main_leftover) Main_top:1(Body27)]
[S] Bonded331 [Board_V3.3 v23:1(Main_leftover) Main_top:1(Back_R_Light)]
[S] Bonded332 [Board_V3.3 v23:1(Main_leftover) Main_btm:1]
[S] Bonded333 [Board_V3.3 v23:1(Main_leftover) Main_btm:1]

[S] Bonded334 [Board_V3.3 v23:1(Main_leftover) Main_top:1(Body27)]
[S] Bonded335 [Board_V3.3 v23:1(Main_leftover) Main_top:1(Body27)]
[S] Bonded336 [Board_V3.3 v23:1(Main_leftover) Main_btm:1]
[S] Bonded337 [Board_V3.3 v23:1(Main_leftover) Main_btm:1]
[S] Bonded338 [Board_V3.3 v23:1(Main_leftover) Main_top:1(Body27)]
[S] Bonded339 [Board_V3.3 v23:1(Main_leftover (1)) Board_V3.3 v23:1(Original_Stud4 (1))]
[S] Bonded340 [Board_V3.3 v23:1(Main_leftover (1)) Board_V3.3 v23:1(Original_Stud3 (1))]
[S] Bonded341 [Board_V3.3 v23:1(Main_leftover (1)) Board_V3.3 v23:1(Original_Stud2 (1))]
[S] Bonded342 [Board_V3.3 v23:1(Main_leftover (1)) Board_V3.3 v23:1(Original_Stud1 (1))]
[S] Bonded343 [Board_V3.3 v23:1(Main_leftover (1)) Main_btm:1]
[S] Bonded344 [Board_V3.3 v23:1(Main_leftover (1)) Main_btm:1]
[S] Bonded345 [Board_V3.3 v23:1(Main_leftover (1)) Main_btm:1]
[S] Bonded346 [Board_V3.3 v23:1(Main_leftover (1)) Main_btm:1]
[S] Bonded347 [Board_V3.3 v23:1(Main_leftover (1)) Main_top:1(Body27)]
[S] Bonded348 [Board_V3.3 v23:1(Main_leftover (1)) Main_top:1(Body27)]
[S] Bonded349 [Board_V3.3 v23:1(Main_leftover (1)) Main_top:1(Body27)]
[S] Bonded350 [Board_V3.3 v23:1(Main_leftover (1)) Main_top:1(Body27)]
[S] Bonded351 [Board_V3.3 v23:1(Main_leftover (1)) Main_top:1(Body27)]
[S] Bonded352 [Board_V3.3 v23:1(Main_leftover (1)) Main_top:1(Body27)]
[S] Bonded353 [Board_V3.3 v23:1(Main_leftover (1)) Main_top:1(Body27)]
[S] Bonded354 [Board_V3.3 v23:1(Main_leftover (1)) Main_top:1(Body27)]
[S] Bonded355 [Board_V3.3 v23:1(Main_leftover (1)) Main_top:1(Body27)]
[S] Bonded356 [Board_V3.3 v23:1(Main_leftover (1)) Main_btm:1]
[S] Bonded357 [Board_V3.3 v23:1(Main_leftover (1)) Main_btm:1]
[S] Bonded358 [Board_V3.3 v23:1(Main_leftover (1)) Main_btm:1]
[S] Bonded359 [Board_V3.3 v23:1(Main_leftover (1)) Main_btm:1]
[S] Bonded360 [Board_V3.3 v23:1(Main_leftover (1)) Main_top:1(Body27)]
[S] Bonded361 [Board_V3.3 v23:1(Main_leftover (1)) Main_top:1(Body27)]
[S] Bonded362 [Board_V3.3 v23:1(Main_leftover (1)) Main_top:1(Body27)]
[S] Bonded363 [Board_V3.3 v23:1(Main_leftover (1)) Main_btm:1]
[S] Bonded364 [Board_V3.3 v23:1(Main_leftover (1)) Main_btm:1]
[S] Bonded365 [Board_V3.3 v23:1(Main_leftover (1)) Main_btm:1]
[S] Bonded366 [Board_V3.3 v23:1(Main_leftover (1)) Main_btm:1]
[S] Bonded367 [Board_V3.3 v23:1(Main_leftover (1)) Main_btm:1]
[S] Bonded368 [Board_V3.3 v23:1(Main_leftover (1)) Main_top:1(Body27)]
[S] Bonded369 [Board_V3.3 v23:1(Main_leftover (1)) Main_top:1(Body27)]
[S] Bonded370 [Board_V3.3 v23:1(Main_leftover (1)) Main_top:1(Body27)]
[S] Bonded371 [Board_V3.3 v23:1(Main_leftover (1)) Main_top:1(Body27)]
[S] Bonded372 [Board_V3.3 v23:1(Main_leftover (1)) Main_top:1(Body27)]
[S] Bonded373 [Board_V3.3 v23:1(Main_leftover (1)) Main_top:1(Front_L_Light)]
[S] Bonded374 [Board_V3.3 v23:1(Main_leftover (1)) Main_btm:1]
[S] Bonded375 [Board_V3.3 v23:1(Main_leftover (1)) Main_btm:1]
[S] Bonded376 [Board_V3.3 v23:1(Main_leftover (1)) Main_top:1(Body27)]
[S] Bonded377 [Board_V3.3 v23:1(Main_leftover (1)) Main_top:1(Body27)]
[S] Bonded378 [Board_V3.3 v23:1(Main_leftover (1)) Main_btm:1]
[S] Bonded379 [Board_V3.3 v23:1(Main_leftover (1)) Main_btm:1]
[S] Bonded380 [Board_V3.3 v23:1(Main_leftover (1)) Main_top:1(Body27)]
[S] Bonded381 [Board_V3.3 v23:1(Main_leftover (1)) Main_btm:1]
[S] Bonded382 [Board_V3.3 v23:1(Main_leftover (1)) Main_btm:1]
[S] Bonded383 [Board_V3.3 v23:1(Main_leftover (1)) Main_top:1(Body27)]
[S] Bonded384 [Board_V3.3 v23:1(Main_leftover (1)) Main_btm:1]
[S] Bonded385 [Board_V3.3 v23:1(Main_leftover (1)) Main_btm:1]
[S] Bonded386 [Board_V3.3 v23:1(Main_leftover (1)) Main_top:1(Body27)]
[S] Bonded387 [Board_V3.3 v23:1(Main_leftover (1)) Main_top:1(Body27)]
[S] Bonded388 [Board_V3.3 v23:1(Main_leftover (1)) Main_btm:1]
[S] Bonded389 [Board_V3.3 v23:1(Main_leftover (1)) Main_btm:1]
[S] Bonded390 [Board_V3.3 v23:1(Main_leftover (1)) Main_btm:1]
[S] Bonded391 [Board_V3.3 v23:1(Main_leftover (1)) Main_btm:1]

[S] Bonded392 [Board_V3.3 v23:1(Main_leftover (1)) Main_btm:1]
[S] Bonded393 [Board_V3.3 v23:1(Main_leftover (1)) Main_top:1(Body27)]
[S] Bonded394 [Board_V3.3 v23:1(Main_leftover (1)) Main_top:1(Body27)]
[S] Bonded395 [Board_V3.3 v23:1(Main_leftover (1)) Main_top:1(Body27)]
[S] Bonded396 [Board_V3.3 v23:1(Main_leftover (1)) Main_top:1(Body27)]
[S] Bonded397 [Board_V3.3 v23:1(Main_leftover (1)) Main_top:1(Body27)]
[S] Bonded398 [Board_V3.3 v23:1(Main_leftover (1)) Main_top:1(Front_R_Light)]

Mesh

Type	Nodes	Elements
Solids	363950	221106

Load Case1

Constraints

Fixed1

Type	Fixed
Ux	Yes
Uy	Yes
Uz	Yes

Selected Entities

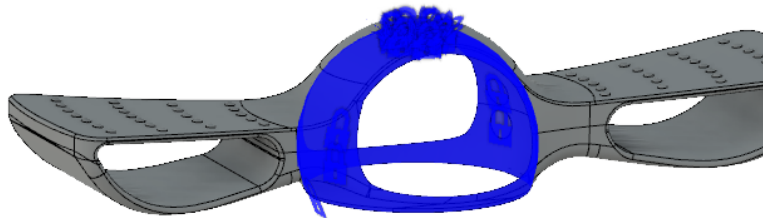

Loads

Force1

Type	Force
Magnitude	980 N
X Value	-76.84 N
Y Value	-977 N
Z Value	0 N
X Angle	0 deg
Y Angle	0 deg
Z Angle	0 deg
Force Per Entity	No

Selected Entities

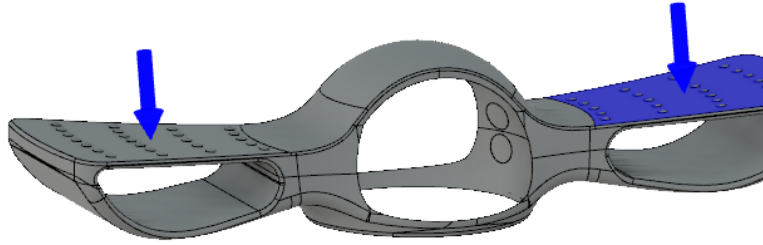

Results

Result Summary

Name	Minimum	Maximum
Safety Factor		
Per Body	0	15
Stress		
Von Mises	0 MPa	147.2 MPa
1st Principal	-226.9 MPa	196.4 MPa
3rd Principal	-381.6 MPa	124.5 MPa
Normal XX	-243.6 MPa	129.3 MPa
Normal YY	-369.2 MPa	194.8 MPa
Normal ZZ	-239 MPa	125.5 MPa
Shear XY	-9.722 MPa	10.6 MPa
Shear YZ	-17.94 MPa	41.48 MPa
Shear ZX	-4.068 MPa	2.405 MPa
Displacement		
Total	0 mm	0.3059 mm
X	-0.04334 mm	0.03912 mm
Y	-0.3039 mm	0.005718 mm
Z	-0.01841 mm	0.0195 mm
Reaction Force		
Total	0 N	18136 N
X	-742.1 N	719.2 N
Y	-18121 N	17831 N
Z	-122.6 N	111.3 N
Strain		
Equivalent	0	0.07116
1st Principal	-7.931E-05	0.03644
3rd Principal	-0.0842	3.419E-05
Normal XX	-0.001807	0.001811
Normal YY	-0.06336	0.03342
Normal ZZ	-0.007839	0.003371
Shear XY	-0.009792	0.01068
Shear YZ	-0.01807	0.04178
Shear ZX	-0.004097	0.002423
Contact Pressure		
Total	0 MPa	97.65 MPa
X	-6.826 MPa	8.838 MPa
Y	-75.62 MPa	97.21 MPa

Z	-7.209 MPa	9.677 MPa
---	------------	-----------

☐ Per Body

0  15

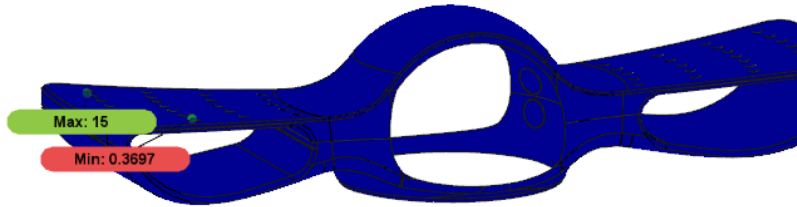

☐ Stress

☐ Von Mises

[MPa] 0  147.2

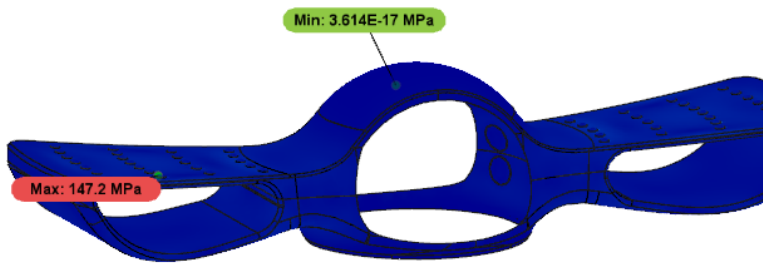

☐ 1st Principal

[MPa] -226.9  196.4

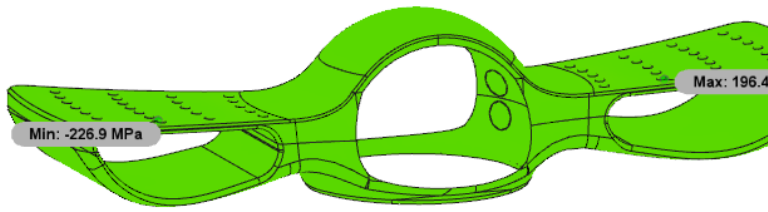

☐ **3rd Principal**

[MPa] -381.6  124.5

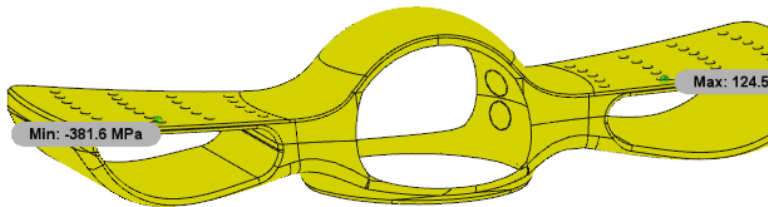

☐ **Displacement**

☐ **Total**

[mm] 0  0.3059

